

Children's

Hospital & Regional Medical Center
4800 Sand Point Way NE
Seattle, WA 98105

**Please join us to view an updated
conceptual model and learn more
about Children's future development.**

Saturday, June 28, 2008

12:30 to 2:30 p.m.

Tuesday, July 8, 2008

5:30 to 7:30 p.m.

Laurelhurst Community Center

4554 NE 41st Street

For more information:

<http://masterplan.seattlechildrens.org>

NON-PROFIT ORG
U.S. POSTAGE
PAID
SEATTLE, WA
PERMIT NO. 8225

View Children's Conceptual Model

Saturday, June 28, 2008
12:30 to 2:30 p.m.

Tuesday, July 8, 2008
5:30 to 7:30 p.m.

Laurelhurst Community Center
4554 NE 41st Street
Refreshments will be provided

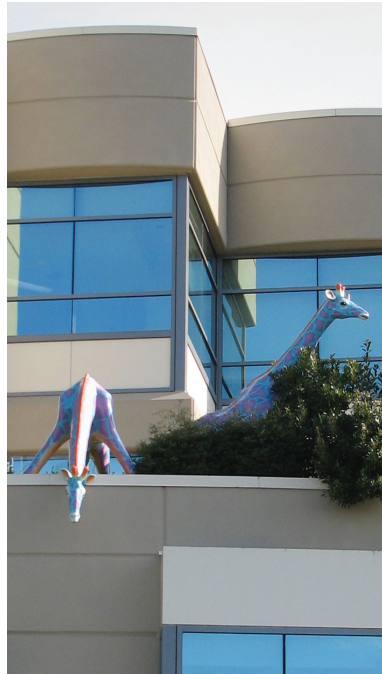
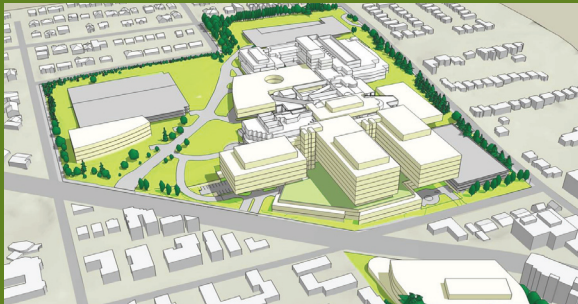

A new alternative

*Alternative 7
(Early Laurelon Development)*

Learn more about the latest alternative, the Draft Environmental Impact Statement comment period and how you can share your input.

Children's staff and architects will be available to answer questions.

<http://masterplan.seattlechildrens.org>

For more information, contact Children's Community Relations staff:

Desiree Leigh, Director of Regional Government Affairs
and Community Relations, **(206) 987-5269**

Martha Tansik, Community Relations Assistant, **(206) 987-4519**